



# DOWNLIGHT D4



1. The luminaire shall be installed by qualified electrician and wired in accordance with the latest IEE electrical regulations or the national requirements.
2. Lightings should not work for a long time above temperature 40° otherwise it will affect its light source life.
3. The luminaire shall under no circumstances be covered with insulation matting or similar material.

## Technical Specifications

Version 1

D4	LED 20W, 1500 lumen LED 30W, 2900 lumen	117	0.8

### Track version - dimensions

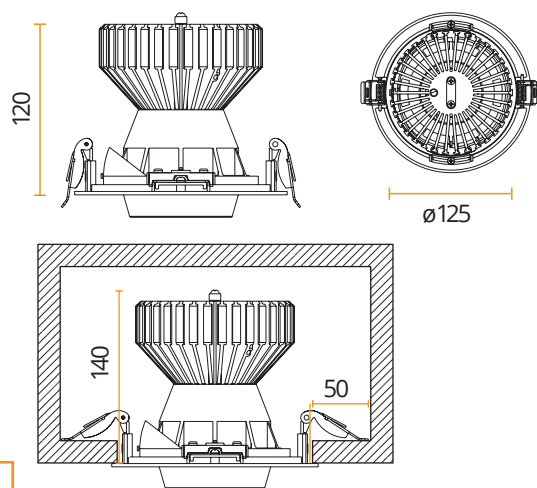

### Connecting line

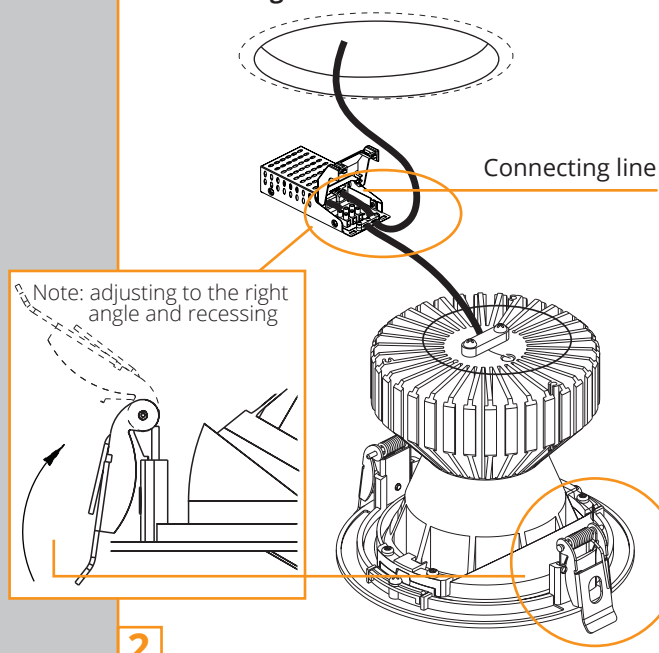

### Rotating angle

